

7 5?" &6  
E 7 666  
< % + )

& . ( & 7 (

5 . . # / 6.

. 7 . ( , & 8 # 2 ' " 1 .  
7 . . 8 ' : # " + 3 1 . / # " (9 .  
6. \$

+ .. . # . , 7 5+, 8  
/ ( . 7 . 75+, \$

2 5 ' ' ; &  
! ( < 2 \*  
, 7 " 8= !)  
" . &  
, . > 7 7 ? 1 7@ A?  
# @

! " # \$ %  
+ ( . 9 . 7 # . 3

& ' \$ !	'
5 " ,... ) . ( # ) & ' : # . ; &\$ 7 6 . 7) & 8 .. # 3 ( = ' > > &7 . & & 6 7 ( 75 ? " 0 . ( &\$	, \$

7 7 % B C D  
! " ###\$ \$% \$ \$  
&! ' ( ! ) \*''\$+ , - \$% \$ \$  
) ./ ' 0 ' ( 1 ! ) , '23&4 4 4

&	' \$ !	'
	" ,... * / . 7 \$ # ( . . . ( 7 .. . 8 .. . # 3 ( = ' 75 ? > > &7 . & & 6 " 0 . ( &F 75 ? " " . 7 . F ? 2 ' " 1 . # " # " . \$	. " . 7 7 " ( \$ ,... * /
&	. ... ( ( # ' : # ) & . " ,... ) . ( 1 \$	, \$

\$  
5 7 . 7 # 3  
G . .. 7 7 7 6.  
# / 7 \$  
( G . .. ( . # 7 . % 7 6.  
\$  
7 7 7 % 77 .  
# . 7 # ( \$  
% \$ " )" ! " # \$ %  
\$ 5 7 . 7 .. 8  
7 77 7 77 . ... . \$  
\$ + .. . # . 7 5+, 8 . 7  
. \$ . 7 . \* 8 % 7 8 7 \$  
+ " \$ "  
\$ + .. . # . 75+, 8 . . 3  
77 # 77 . F  
( 77 .7 . . F  
. . . \$  
\$ + .. . # . 0 7 5+, . & 7  
5 1, 8 # 77 . ( .  
7 # 7 . # 0 7 . 7 . #

5+,\$. 7 # 5+ , 5 1, .  
' 7 7 \$

&\$+ .. . # . 0 ' 7 5+ , . & 75 1 ,  
# . \$ . #  
( 7 ( . ( < 1 \$  
. 7 , 5+ , 5 1, . ' 7 7 \$

+ " !  
5 75 ? " 7 # 7  
3

\$ " ,... \* / , " % A\* % 7  
. # / .. # / . # 6.  
.. . # . && 7 5+ , \$ ( ( . .  
# / 6. \$5 . % 7  
7 # / 8 7 ( " 7 < 7  
! " < ! \$ . . / . \$

+7 7 ( % % ? 8+ ) 8  
, 1 ? ( . . ( \* '\$ + , - \$ % \$ \$  
\$

E .

) : (  
5 #

, . 3, . , A . 7  
, . ' 6 . 75+ ,  
, . 1 6,  
, . 6 " ,... ) .

! +

C % 77 . 3

,... ( # 6. 9 . ( 75 ? " 5+, \$ . 7 5+, # . ( .. ( # 6. \$ 7 ? 1 7@ 6? # @ . # .. . 6. 7 , 7 5+, \$ 5 75 ? " ! " # \$ % \$ & , ( 7 . . . . ( . \$ 1 # G , .. 7 ( \$ 5 .. 7 \$ 7 ( & # \$ # ( # 7 # 6 # .. \$ 7 .. 75 ? " H # . 7 ' : # 7 \$ 5 # .. . ( . 7 7 ' : # 87 .. . ( .. . # \$

< . # . 7 # ( 3

\$ ! , (	-		\$ &	. % " ,
	! =	1 ? . &	6 6	6 6
G . .. 6 . . 3 7 .. ( # 9 . 6 .	7 5 ? "	l &	6 6	6 6
" ? <	7 5 ? "	1 l	6 6	6 6
, = " , 3	,	4 ? &	6 6	6 6

@ + .				
" .	6 6	&	6 6	6 6
#	= '	, > > &	& &	, ,

\*

/ # 0 \$ %

1 " 7 .  
? 7 6 .

---

# 0 1 \$ \$ " 2 3 4

"

5 . # ( . . 0 7  
. . ( .. ( # 6 . 9 .

\$

, # . J  
( .. ( # 6 . .  
# . . . F  
( ( .. .. # / # . . 87 # /  
. # . . . # # D. F  
. ( .. ( # . . F  
.. . .. # / . . F  
. . . F  
7 F  
7 .. # / .. . # . \$  
? ; J \$  
& : # 8 ( . # ( ( .  
( . 7 . 0 \$

!

1 =

5 6 7 % ! 2 \$

, # 7 7 . ( . . ( . &  
/ . 7 ; . # . \$  
5 . 7 7 . #  
# . . % (   
7 7 . \$  
& 5 8 8 J  
# F  
( J  
7 . 7 7 # # ( . F  
! 1 , 5 . \$

5 6 7 \*

5 . . 7 . .  
. & 7 . \$  
+ 7 # . . ( . 7 # 8  
# . . \$  
& 5 5 1 , . 4 4 8 8 & J  
F  
( J  
7 . 7 # ( 7 F  
.  
\$  
( . J  
< 1 .  
. / 8 . , 8 (   
. 7 . F  
( < 1 .  
., . \$

5 . J  
( ( 7 F  
( ( . \$  
( . 7 7 \$  
+ . J  
. . ( . &\$  
. 7; . D . # . 0 \$

8 - \$ ! 2  
 , 7 # 7 . # 0 7 . 7  
 . # ,. \$  
 : # 8 J  
 . 7 . F  
 ( / 7 7 # 0  
 ( .  
 # 0 7 7 \$  
 & + 8 . 7; . ; 7 \$  
 , . ( # # . #  
 . ( # \$

8 / - \$ \$  
 + 7 7 # 7 . 8 7  
 7 . \$  
 5 . . 7 7 . 7 #  
 # ( \$  
 & + 7 . 8 # &  
 ( ( # . 7 # \$  
 5 . 7; . . \$  
 5 . 7 . # . 7  
 . 7 # . 7; . (   
 ( 7 \$  
 5 J  
 ( . . F  
 ( 7 . 7 ( F  
 . ( / ( \$  
 5 7 . ; # . 7  
 ; . # . #  
 . ( . . 7 # 7  
 . ! 1, 5 ,. \$  
 0 5 / 7 . 7 7 . . 8 . 7  
 . 8 \$

4 + . J  
 J  
 7 # . ( # ( ! 1,5 J ! 1,5 F  
 ( 7 # . ( . J . \$

87 \$ 3  
 , # . # J  
 7 . J 0 7 . #  
 F  
 ( 7 . 7; . / . 7 . & J  
 7 # \$  
 : # 8 J  
 . 7 . F  
 ( / 7 7 # 0  
 ( . F  
 # 0 7 7 \$  
 &, 8 . ; 7 \$



Modified in red by the Department of Transport  
and Main Roads on 18 October 2023

SITE PLAN  
scale 1:100 @ A1

Site Cover - 47.4%

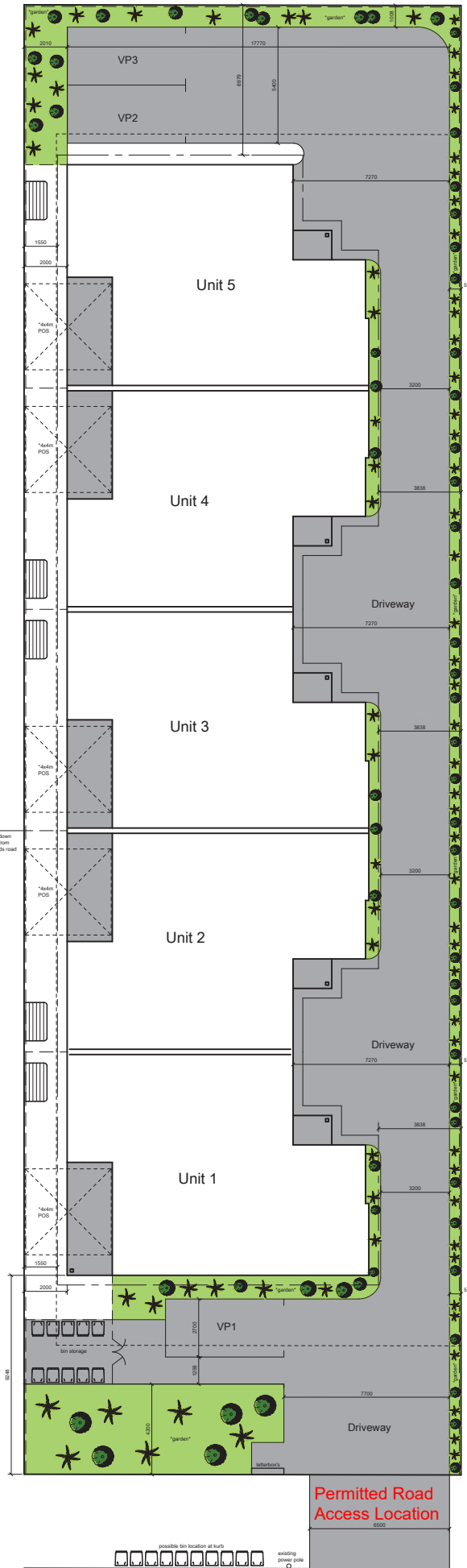

Dalgangal Road



G.D.C. No: 15243624  
P.O. Box 1530  
Bentley WA 6105  
Ph: (07) 41531183  
Email: [info@gatleybuildingdesign.com.au](mailto:info@gatleybuildingdesign.com.au)  
Web: [www.gatleybuildingdesign.com.au](http://www.gatleybuildingdesign.com.au)

Site: NO. 22 DALGANGAL ROAD,  
GAYNDAH  
LOT 21 - SP203542  
Project: PROPOSED DWELLING  
Client: T. Boscos  
Description: SITE PLAN.

Rev	Description	Date
-	-	-
1	Preliminary	24/02/23
© Copyright 2023, John Gatley Building Designs.		
Design: R.B.	Drawn: R.B.	Approved: J.G.
Drawing No: 23131	Page: 01	

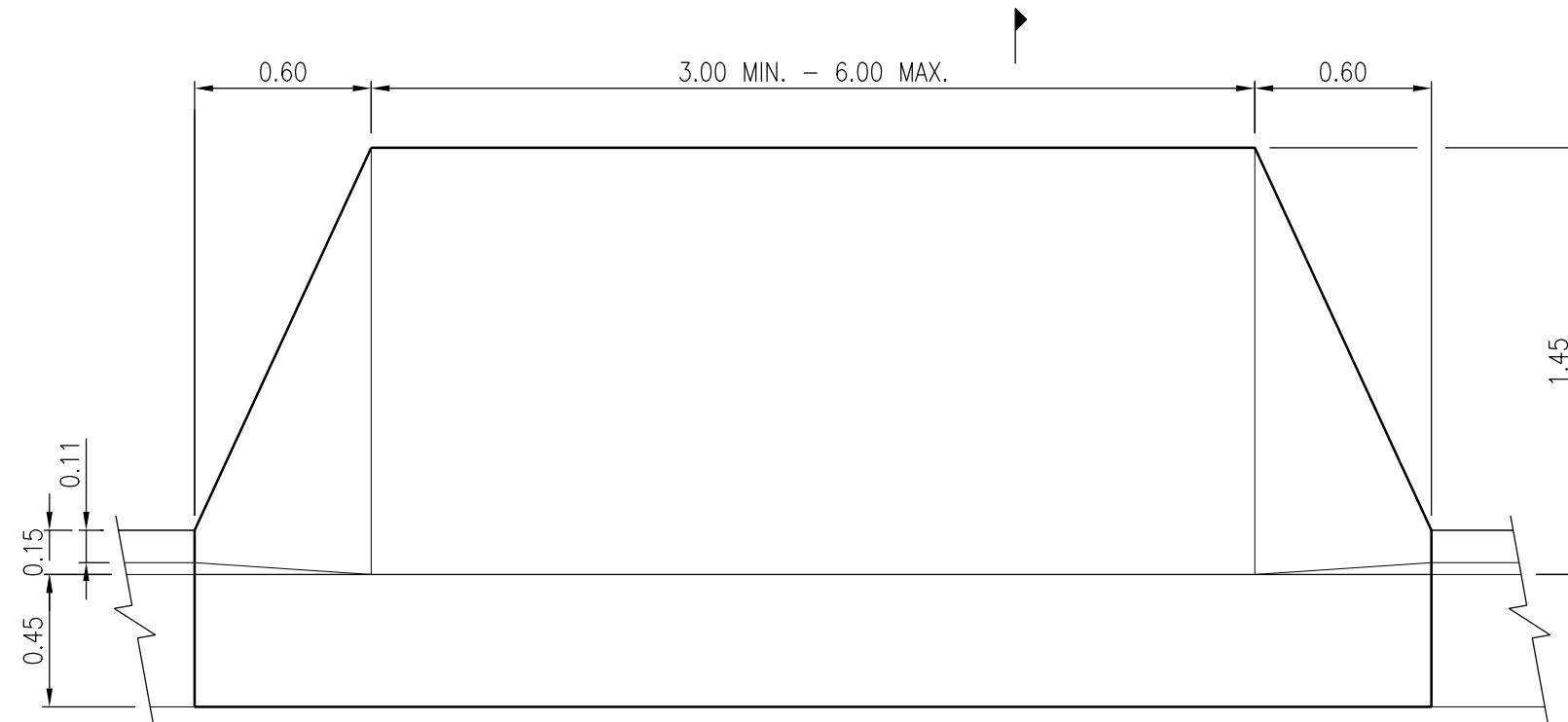

CHANNEL KERB B1  
PLAN

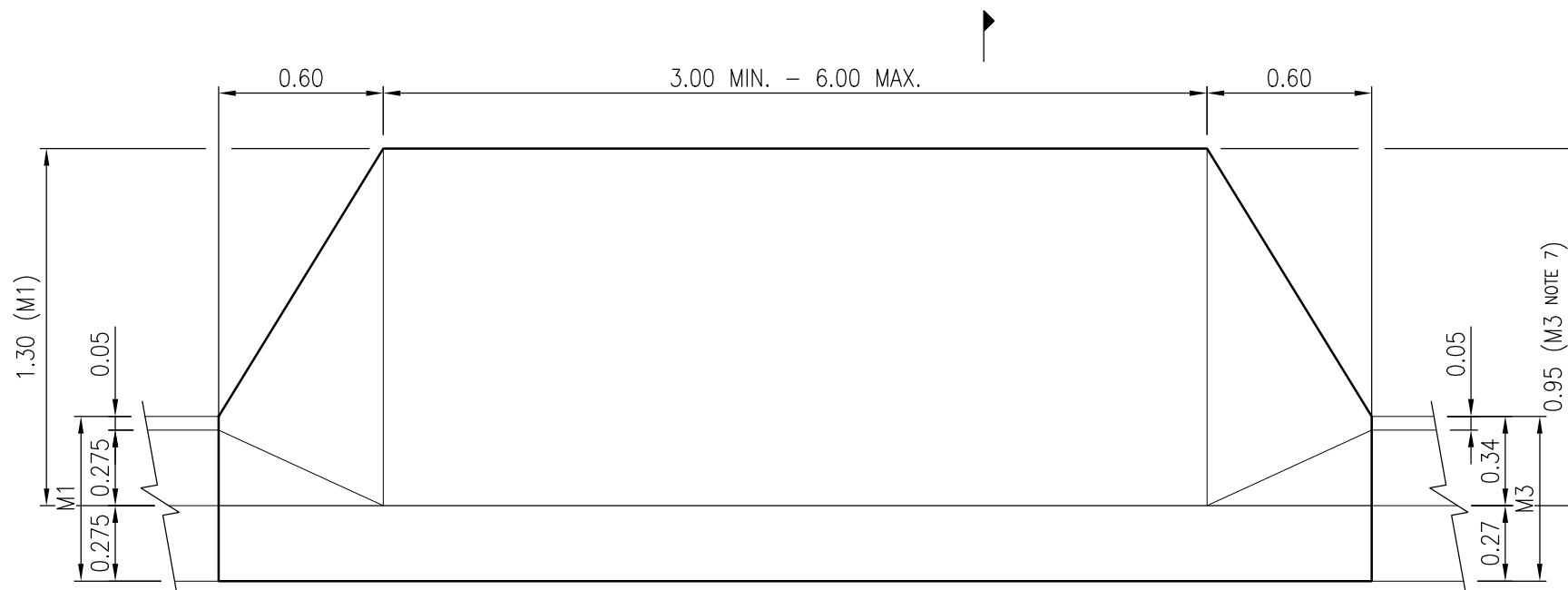

CHANNEL KERB M1 / M3 (NOTE 7)  
PLAN

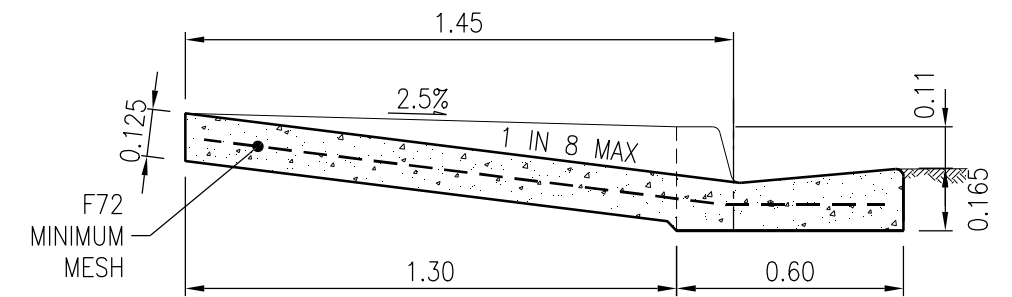

SECTION A-A (RESIDENTIAL)  
B1

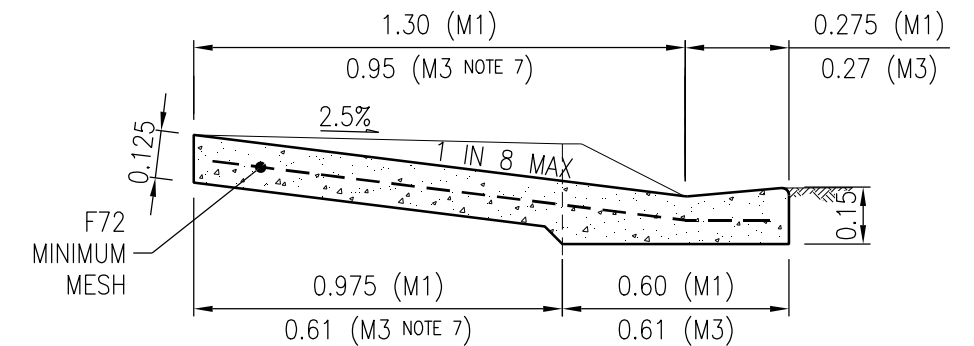

SECTION B-B (RESIDENTIAL)  
M1 / M3 (NOTE 7)

#### NOTES:

1. FOOTPATH SECTION TO VARY WHERE NECESSARY TO MATCH CONCRETE FOOTPATHS AND VERGE PROFILES. FOOTPATH EARTHWORKS ADJOINING CONCRETE MUST BE WELL COMPACTED.
2. RESIDENTIAL CROSSINGS CAN BE 3m MIN. TO 6m MAX.
3. ALL DIMENSIONS ARE IN METRES.
4. FOR KERB TYPES, REFER NBRC STANDARD DRAWING R1020.
5. COUNCIL WILL NOT GUARANTEE REINSTATEMENT OF NON-STANDARD CONCRETE FINISHES IF COUNCIL NEEDS TO ACCESS INFRASTRUCTURE UNDER DRIVEWAY (EG. PIPES ETC) AND INSTALL CONCRETE FOOTPATHS TO COUNCIL STANDARDS.
6. FOR SECTIONAL DETAILS ON FOOTPATH/DRIVEWAY ACCESS SEE NORTH BURNETT REGIONAL COUNCIL PLAN R1010.
7. M3 – GENERALLY M3 IS TO REMAIN AS IS FOR VEHICLE CROSSING. IF REMOVAL & RECONSTRUCTION OF M3 IS REQUIRED, THEN SPECIAL APPROVAL FROM COUNCIL IS REQUIRED.

Scales

NOT TO SCALE

Revisions

Revisions	Verified	Date
A	Original Issue	

Quality Certification

Design: BRC	Verified: JJC
Drawn: BRC	Checked: JJC
Approved By Engineer:	
J Crick RPEQ 7834	
6/06/2020	



## DRIVEWAYS

### Residential Invert Crossings

### (Layback M1 & M3, & Standard Kerb & Channel)

Standard  
Drawing

No.: NBRC  
R1014

Sheet  
Size:  
A3

Rev.:  
A

## Getting a Road Works Approval (under section 33 of the Transport Infrastructure Act 1994) to undertake works required by a development approval condition

All road works within the State-controlled road must be constructed in accordance with the Department of Transport and Main Roads' (TMR) standards for road works. Construction must be managed to ensure no adverse safety impacts for road users and construction workers. The details about the road works required are included as conditions of approval on the concurrence agency response given by the State Assessment and Referral Agency as part of the development assessment process.

**Even though a development approval has been given by Council it is still necessary to obtain approval to construct road access works within the State-controlled road from TMR.**

### Step 1: Application

The road works application must be made on the approved form which is available from the local TMR office (contact details on the back of this page) or at <http://www.tmr.qld.gov.au/Community-and-environment/Planning-and-development/Other-matters-requiring-approval.aspx>

#### What you need to provide

The information that is required by TMR to assess an application for Road Works approval will largely depend upon the size and scale of the road works to be constructed. In all cases, detailed design of the road work consistent with the requirements of the conditions of approval, conforming to the requirements of the Road Planning and Design Manual and certified by a Registered Professional Engineer Queensland will be necessary. The following are examples of the types of issues that may need to be addressed in the detailed design:

- horizontal and vertical alignment of the works
- cross sections
- property accesses
- drainage design
- pavement design
- signage and pavement marking
- relocating of utilities
- sight distances
- speed environment
- details about the estimated cost of the works (for calculating bond amount if required)

To determine exactly what information is required by TMR, it is recommended you contact your local TMR office.

#### The road works approval process takes time.

The amount of time depends on the road works required. For this reason, it is important you contact TMR as soon as possible to ensure that obtaining approval does not delay construction.

### Step 2: Approval to construct the works

Where road access works may pose a safety risk to road users, approval may be conditional upon providing TMR a traffic management plan before construction begins.

Depending on the nature of the works proposed, TMR may require a performance bond to ensure the works are completed as required.

These conditions will be included in the road access works approval. When all conditions of the road access approval have been fulfilled, TMR will issue an authority to commence construction and work may begin

#### What you need to provide

Before construction can begin TMR may require:

- a meeting onsite prior to the start of construction
- the proposed timing and duration of works; and/or
- an indemnity signed by the contractor
- a performance bond
- a traffic management plan

### Step 3: Evidence of Construction of the Road Works

TMR may need you to provide evidence that the road works were constructed as approved. This is likely to require the provision of the "as constructed" drawings. The return of any bond may be dependent upon the provision of these drawings.

**Important Note:**

It is important to read and understand all approvals given to you by TMR as you must comply with them. If you do not understand something or have any additional questions, do not hesitate to contact the TMR office that issued the approval.

**Contact details for Transport and Main Roads offices**

To lodge your application or if you require any assistance with finalising your application email, contact your local TMR office. To find out which office is your local office, call 132380 or go to [www.tmr.qld.gov.au/About-us/Contact-us/In-person/Roads-offices.aspx](http://www.tmr.qld.gov.au/About-us/Contact-us/In-person/Roads-offices.aspx)

Office	Email	Phone
Barcaldine	<a href="mailto:barcaldine.office@tmr.qld.gov.au">barcaldine.office@tmr.qld.gov.au</a>	4651 2777
Rockhampton	<a href="mailto:corridormangement@tmr.qld.gov.au">corridormangement@tmr.qld.gov.au</a>	4931 1559
Roma	<a href="mailto:downsswr.office@tmr.qld.gov.au">downsswr.office@tmr.qld.gov.au</a>	4622 9511
Toowoomba	<a href="mailto:downsswr.office@tmr.qld.gov.au">downsswr.office@tmr.qld.gov.au</a>	4639 0777
Cairns	<a href="mailto:cairns.office@tmr.qld.gov.au">cairns.office@tmr.qld.gov.au</a>	4045 7144
Mackay	<a href="mailto:mackay.whitsunday.idas@tmr.qld.gov.au">mackay.whitsunday.idas@tmr.qld.gov.au</a>	4951 8555
Brisbane	<a href="mailto:metropolitan.idas@tmr.qld.gov.au">metropolitan.idas@tmr.qld.gov.au</a>	3066 5499
Maroochydore	<a href="mailto:north.coast.idas@tmr.qld.gov.au">north.coast.idas@tmr.qld.gov.au</a>	5451 7055
Cloncurry	<a href="mailto:cloncurry.office@tmr.qld.gov.au">cloncurry.office@tmr.qld.gov.au</a>	4769 3200
Townsville	<a href="mailto:towdawe@tmr.qld.gov.au">towdawe@tmr.qld.gov.au</a>	4421 8700
Gold Coast	<a href="mailto:scrcmallocations@tmr.qld.gov.au">scrcmallocations@tmr.qld.gov.au</a>	5563 6600
Bundaberg	<a href="mailto:wide.bay.burnett.idas@tmr.qld.gov.au">wide.bay.burnett.idas@tmr.qld.gov.au</a>	4154 0200